

Sycamore

With traditional features, the **Sycamore** is a great value. Three bedrooms, two and a half bathrooms and a full basement compliment this plan. With a host of options, this plan can easily meet your needs.



Front Elevation - Option A

Floor Plan - first floor ➔

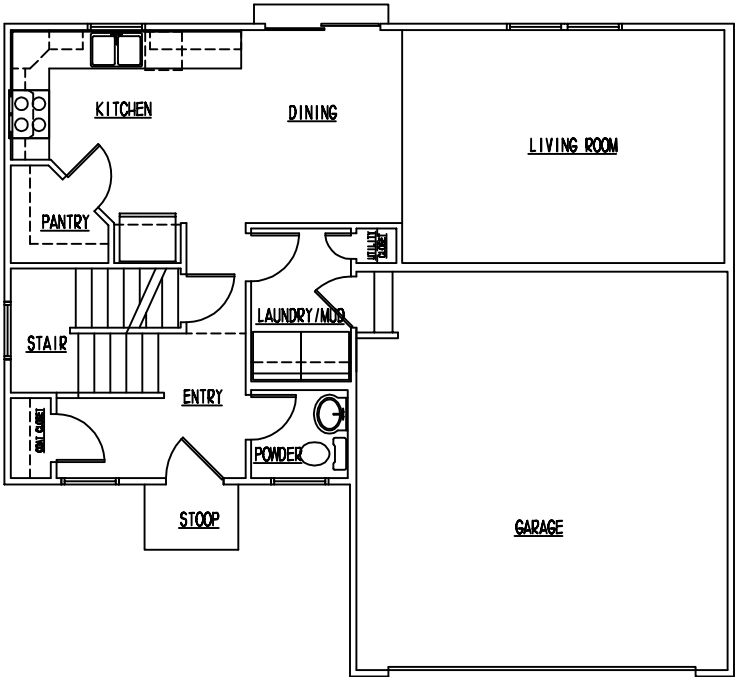

Front Elevation - Option B

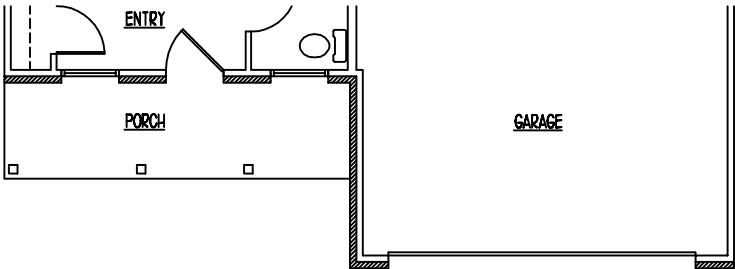

Option B Floor Plan - first floor
added covered porch

Floor Plan - second floor

